

BUS TURN AROUND

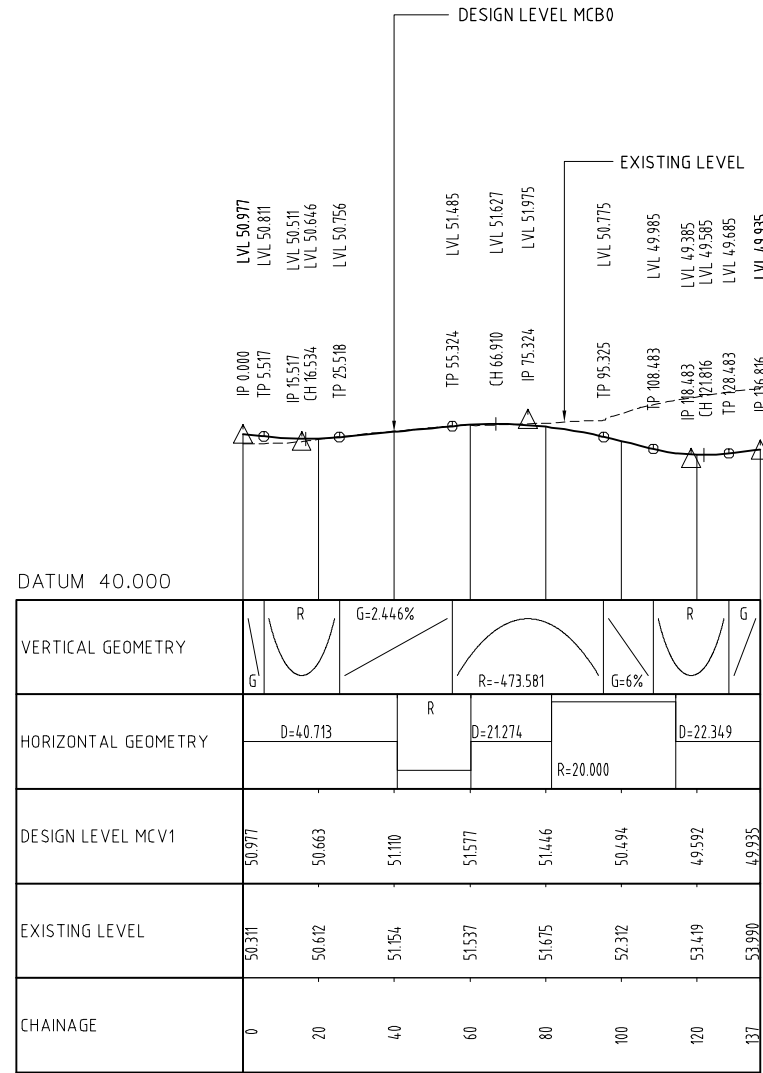

ROTHON DRIVE ACCESS

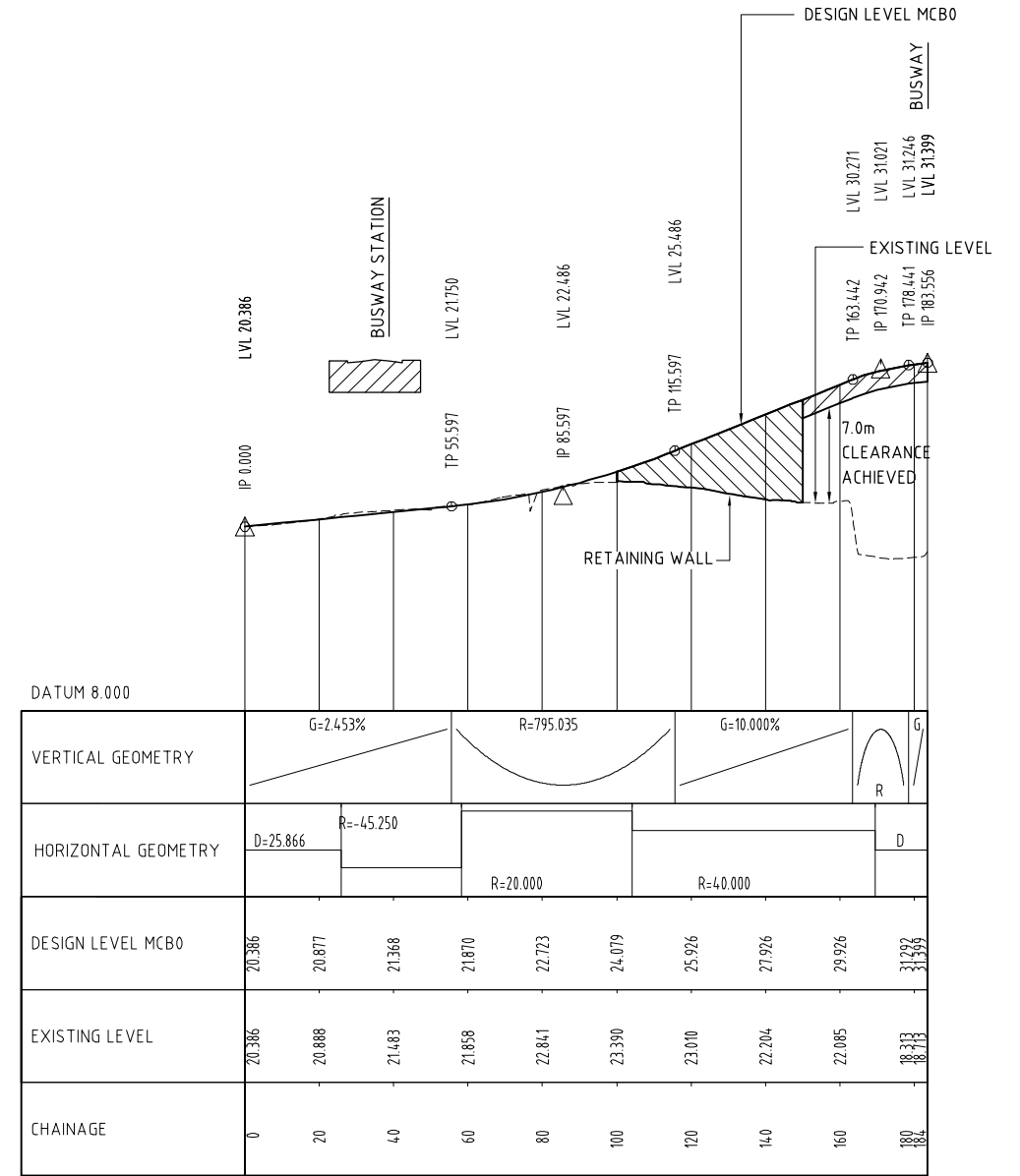

SPRINGWOOD BUSWAY STATION ACCESS RAMP

CONCEPT DESIGN
NOT FOR CONSTRUCTION

REV	DATE	DESCRIPTION	DRAWN	CHECK	DESIGN	VERIFY
B	14.09.09	BUS TURN AROUND ADDED; ROTHON DRIVE AMENDED	WIN	DSB	DSB	
A	1.12.08	ORIGINAL ISSUE	MB	DSB	DSB	BJK

© Parsons Brinckerhoff Australia Pty Limited ("PB")
Copyright in the drawings, information and data recorded in this document ("the information") is the property of PB. This document and the information are solely for the use of the authorised recipient and this document may not be used, copied or reproduced in whole or part for any purpose other than that for which it was supplied by PB. PB makes no representation, undertakes no duty and accepts no responsibility to any third party who may use or rely upon this document or the information.

NCSI certified Quality System to ISO 9001

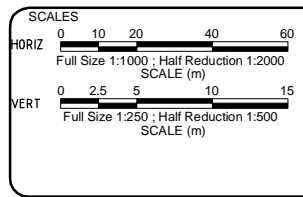

A1 ORIGINAL
DO NOT SCALE THIS DRAWING - USE FIGURED DIMENSIONS ONLY
VERIFY ALL DIMENSIONS ON SITE

APPROVED FOR AND ON BEHALF OF
PARSONS BRINCKERHOFF AUSTRALIA PTY LIMITED

SIGNED: _____
DATE: _____

RPEQ No. _____

Adelaide, Brisbane, Melbourne, Newcastle, Perth, Singapore, Sunshine Coast and Sydney

Level 4, Northbank Plaza
69 Ann Street
GPO BOX 2907
Brisbane QLD 4001
Australia

Telephone +61 7 3854 6200
Facsimile +61 7 3854 6500
Email: brisbane@pb.com.au

CLIENT

PROJECT			
SOUTH EAST BUSWAY EXTENSION-STAGE 2			
ROAD LONGITUDINAL SECTIONS			
ROTHON DRIVE ACCESS			
SPRINGWOOD BUSWAY STATION ACCESS RAMP			
PROJECT No.	DISCIPLINE	NUMBER	REV.
2112646A	- TRA	0041	B

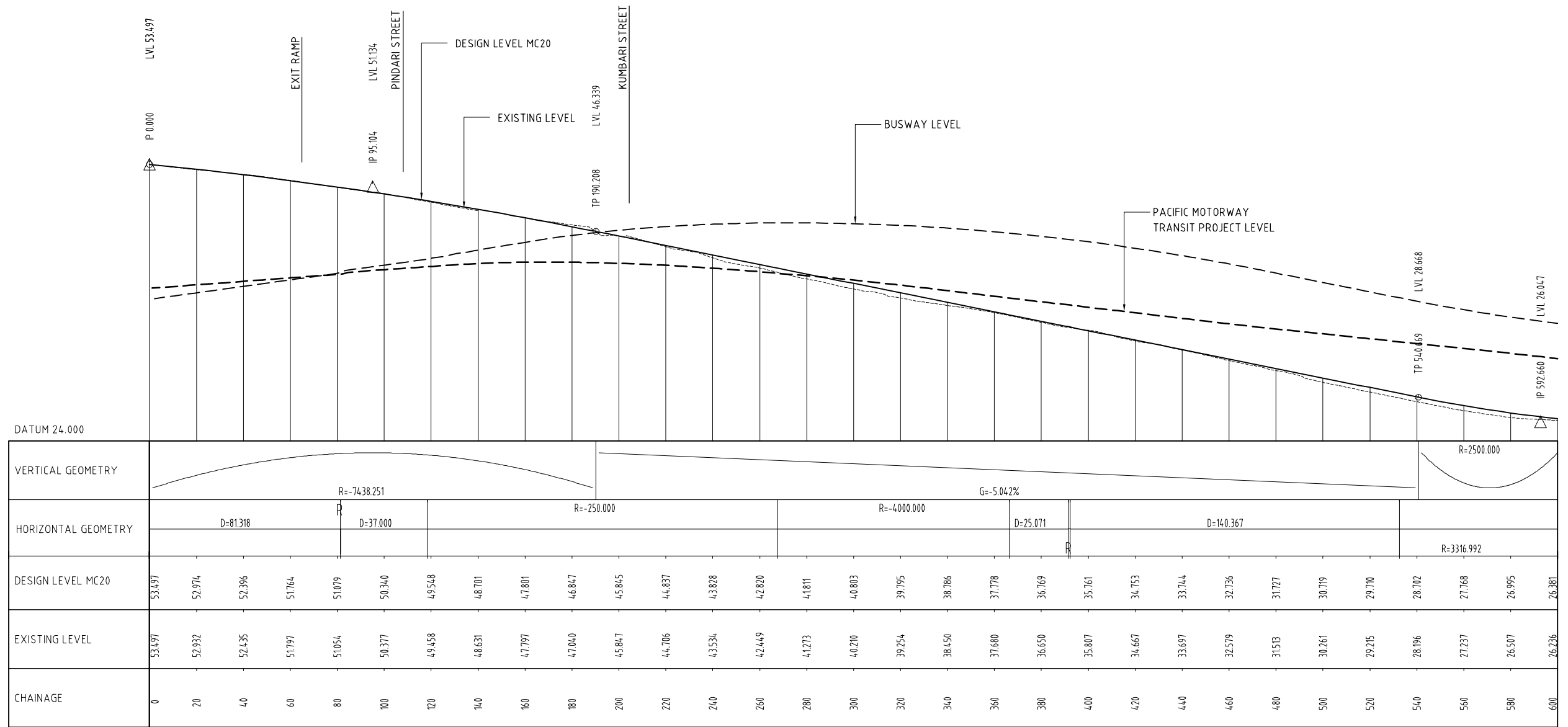

ROCHEDALE ROAD

CONCEPT DESIGN
NOT FOR CONSTRUCTION

REV	DATE	DESCRIPTION	DRAWN	CHECK	DESIGN	VERIFY
B	14.09.09	KUMBARI ST AMENDED	WIN	DSB	DSB	
A	1.12.08	ORIGINAL ISSUE	MB	DSB	DSB	BJK

© Parsons Brinckerhoff Australia Pty Limited ("PB")
Copyright in the drawings, information and data recorded in this document ("the information") is the property of PB. This document and the information are solely for the use of the authorised recipient and this document may not be used, copied or reproduced in whole or part for any purpose other than that for which it was supplied by PB. PB makes no representation, undertakes no duty and accepts no responsibility to any third party who may use or rely upon this document or the information.

NCSI certified Quality System to ISO 9001

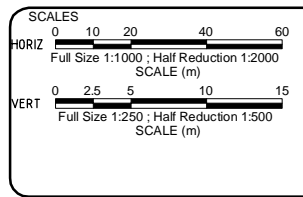

A1 ORIGINAL
DO NOT SCALE THIS DRAWING - USE FIGURED DIMENSIONS ONLY
VERIFY ALL DIMENSIONS ON SITE

APPROVED FOR AND ON BEHALF OF
PARSONS BRINCKERHOFF AUSTRALIA PTY LIMITED

SIGNED _____
DATE _____

RPEQ No. _____

PARSONS BRINCKERHOFF

Adelaide, Brisbane, Melbourne, Newcastle, Perth, Singapore, Sunshine Coast and Sydney

Level 4, Northbank Plaza
69 Ann Street
GPO BOX 2907
Brisbane QLD 4001
Australia

Telephone +61 7 3854 6200
Facsimile +61 7 3854 6500
Email: brisbane@pb.com.au

CLIENT

Queensland Government

PROJECT

SOUTH EAST BUSWAY EXTENSION-STAGE 2

ROAD LONGITUDINAL SECTION
ROCHEDALE ROAD
SHEET 1

PROJECT No.	DISCIPLINE	NUMBER	REV.
2112646A	- TRA -	0042	B

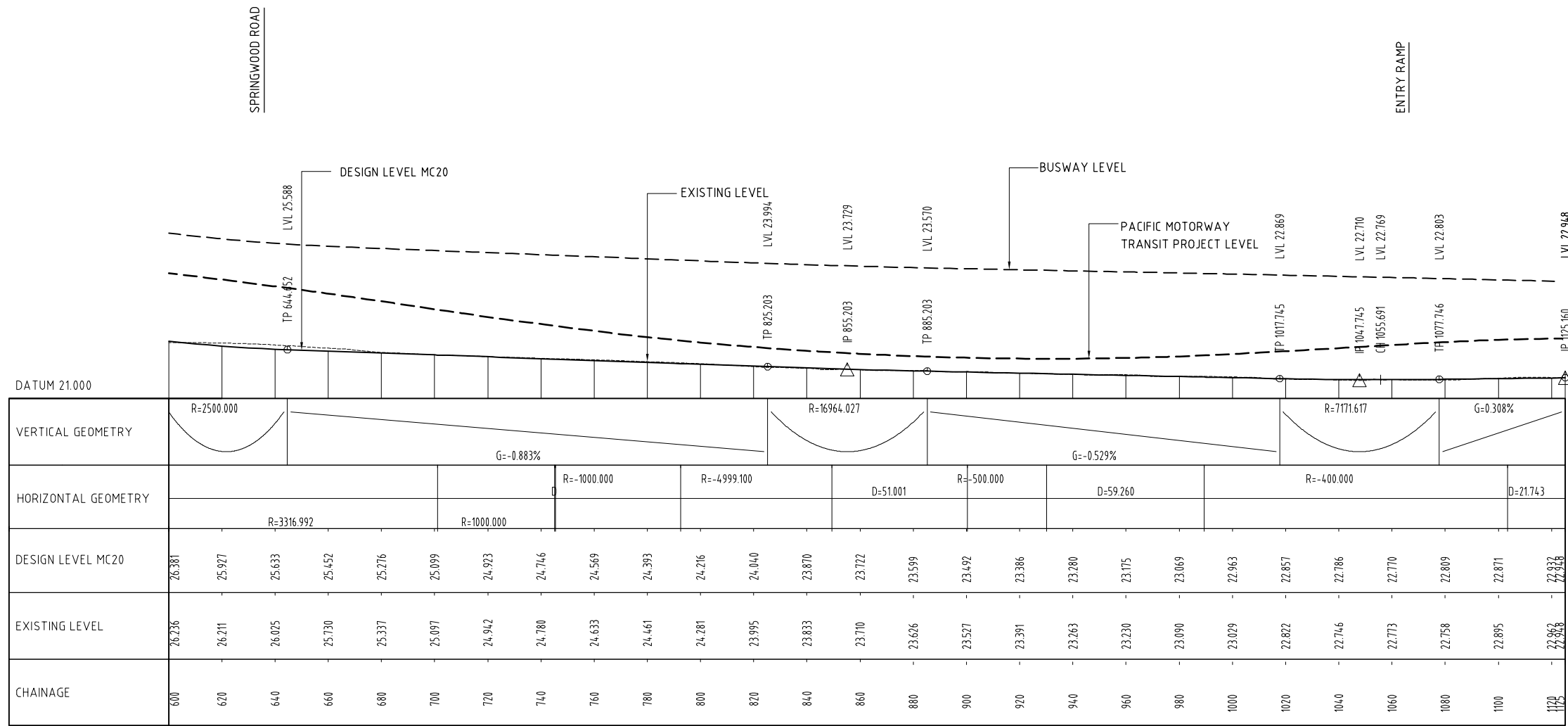

ROCHEDALE ROAD

CONCEPT DESIGN
NOT FOR CONSTRUCTION

REV	DATE	DESCRIPTION	DRAWN	CHECK	DESIGN	VERIFY
A	1.12.08	ORIGINAL ISSUE	MB	DSB	DSB	BJK

© Parsons Brinckerhoff Australia Pty Limited ("PB")
Copyright in the drawings, information and data recorded in this document ("the information") is the property of PB. This document and the information are solely for the use of the authorised recipient and this document may not be used, copied or reproduced in whole or part for any purpose other than that for which it was supplied by PB. PB makes no representation, undertakes no duty and accepts no responsibility to any third party who may use or rely upon this document or the information.

NCSI certified Quality System to ISO 9001

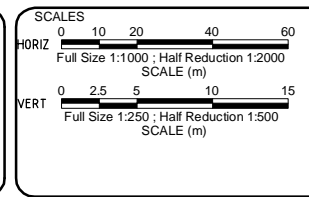

A1 ORIGINAL
DO NOT SCALE THIS DRAWING - USE FIGURED DIMENSIONS ONLY
VERIFY ALL DIMENSIONS ON SITE

APPROVED FOR AND ON BEHALF OF
PARSONS BRINCKERHOFF AUSTRALIA PTY LIMITED

SIGNED: _____
DATE: _____

PARSONS BRINCKERHOFF

Adelaide, Brisbane, Melbourne, Newcastle, Perth, Singapore, Sunshine Coast and Sydney

Level 4, Northbank Plaza
69 Ann Street
GPO BOX 2907
Brisbane QLD 4001
Australia

ABN 80 078 004 798

Telephone +61 7 3854 6200
Facsimile +61 7 3854 6500
Email: brisbane@pb.com.au

CLIENT

Queensland Government

PROJECT			
SOUTH EAST BUSWAY EXTENSION-STAGE 2			
ROAD LONGITUDINAL SECTION ROCHEDALE ROAD SHEET 2			
PROJECT No.	DISCIPLINE	NUMBER	REV.
2112646A	- TRA -	0043	A

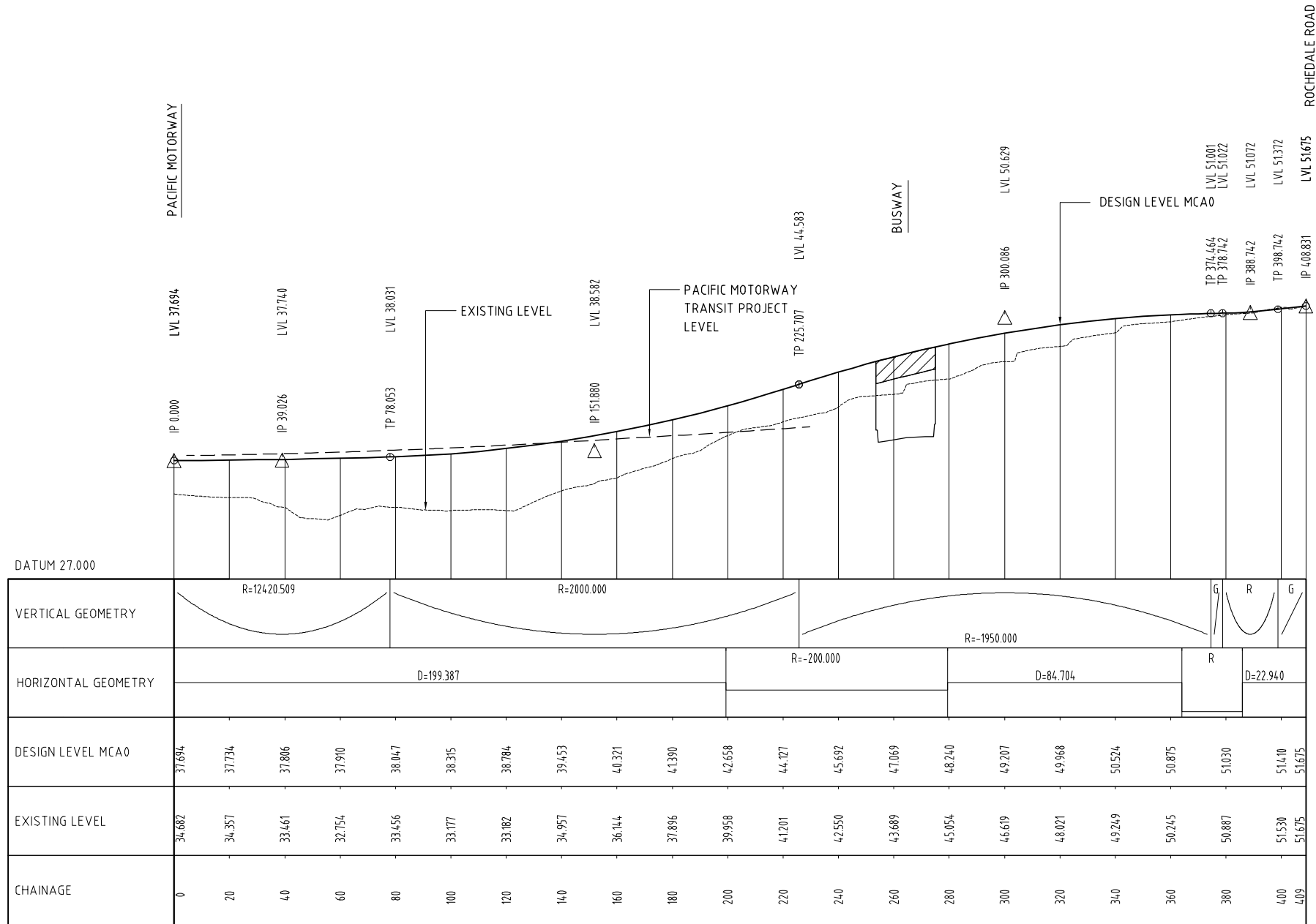

ROCHEDALE ROAD EXIT RAMP

CONCEPT DESIGN
NOT FOR CONSTRUCTION

REV	DATE	DESCRIPTION	DRAWN	CHECK	DESIGN	VERIFY
A	1.12.08	ORIGINAL ISSUE	MB	DSB	DSB	BJK

© Parsons Brinckerhoff Australia Pty Limited ("PB")
Copyright in the drawings, information and data recorded in this document ("the information") is the property of PB. This document and the information are solely for the use of the authorised recipient and this document may not be used, copied or reproduced in whole or part for any purpose other than that for which it was supplied by PB. PB makes no representation, undertakes no duty and accepts no responsibility to any third party who may use or rely upon this document or the information.

NCSI certified Quality System to ISO 9001

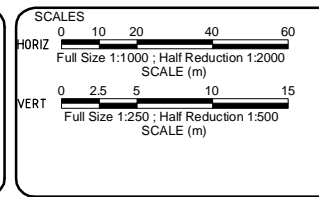

A1 ORIGINAL
DO NOT SCALE THIS DRAWING - USE FIGURED DIMENSIONS ONLY
VERIFY ALL DIMENSIONS ON SITE

APPROVED FOR AND ON BEHALF OF
PARSONS BRINCKERHOFF AUSTRALIA PTY LIMITED

SIGNED: _____
DATE: _____

RPEQ No. _____

PARSONS BRINCKERHOFF

Adelaide, Brisbane, Melbourne, Newcastle, Perth, Singapore, Sunshine Coast and Sydney

Level 4, Northbank Plaza
69 Ann Street
GPO BOX 2907
Brisbane QLD 4001
Australia

Telephone +61 7 3854 6200
Facsimile +61 7 3854 6500
Email: brisbane@pb.com.au

CLIENT

Queensland Government

PROJECT			
SOUTH EAST BUSWAY EXTENSION-STAGE 2			
ROAD LONGITUDINAL SECTION ROCHEDALE ROAD EXIT RAMP			
PROJECT No.	DISCIPLINE	NUMBER	REV.
2112646A	- TRA	0044	A